

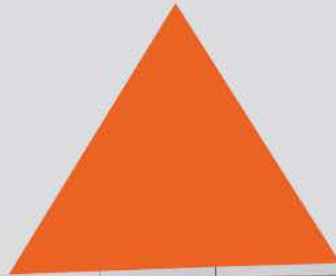

SHINE KITCHEN MOBILIARIO



LA ELEGANCIA COMPLETAMENTE
EN ACERO INOX



CONJUNTO Shine kitchen

SHINE KITCHEN



ARMARIO PARED
PP/630DX



ARMARIO PARED
PPV/630SX



**ARMARIO PARED
ANGULAR**
PPA/680



**ARMARIO
ESCURREPLATOS**
PPS/690



**CONJUNTO FREGADERO
CON MUEBLE**
L/6122DX+BPL/690+BC4/630



**FREGADERO CON
MUEBLE ANGULAR**
BPAL/680+LA/680

SHINE KITCHEN

MOD. COD.	DESCRIZIONE/DESCRIPTION/BEZEICHNUNG/DESCRIPTION/DESCRIPCIÓN DIMENSIONI/DIMENSIONS/ABMESSUNGEN/DIMENSIONS/DIMENSIONES	PREZZO/PRICE PREIS/PRIX/PRECIO € KG / M ³
BC4/630 01070304	<ul style="list-style-type: none"> 4 CASSETTI cm.21,8x52x8,9 • 4 Drawers cm.21,8x52x8,9 • 4 Schubladen cm.21,8x52x8,9 • 4 Tiroirs cm.21,8x52x8,9 • 4 Cajones cm.21,8x52x8,9 cm. 30x56,6x79h 	1.109,00 37 / 0,20
BC2/640 01070402	<ul style="list-style-type: none"> 2 CASSETTI cm.31,8x52x25 • 2 Drawers cm.31,8x52x25 • 2 Schubladen cm.31,8x52x25 • 2 Tiroirs cm.31,8x52x25 • 2 Cajones cm.31,8x52x25 cm. 40x56,6x79h 	1.004,00 35 / 0,26
BC3/640 01070403	<ul style="list-style-type: none"> 3 CASSETTI cm.31,8x52x14,3 • 3 Drawers cm.31,8x52x14,3 • 3 Schubladen cm.31,8x52x14,3 • 3 Tiroirs cm.31,8x52x14,3 • 3 Cajones cm.31,8x52x14,3 cm. 40x56,6x79h 	1.041,00 39 / 0,26
BC4/640 01070404	<ul style="list-style-type: none"> 4 CASSETTI cm.31,8x52x8,9 • 4 Drawers cm.31,8x52x8,9 • 4 Schubladen cm.31,8x52x8,9 • 4 Tiroirs cm.31,8x52x8,9 • 4 Cajones cm.31,8x52x8,9 cm. 40x56,6x79h 	1.178,00 42 / 0,26
BC2/645 01070452	<ul style="list-style-type: none"> 2 CASSETTI cm.36,8x52x25 • 2 Drawers cm.36,8x52x25 • 2 Schubladen cm.36,8x52x25 • 2 Tiroirs cm.36,8x52x25 • 2 Cajones cm.36,8x52x25 cm. 45x56,6x79h 	1.109,00 37,5 / 0,29
BC3/645 01070453	<ul style="list-style-type: none"> 3 CASSETTI cm.36,8x52x14,3 • 3 Drawers cm.36,8x52x14,3 • 3 Schubladen cm.36,8x52x14,3 • 3 Tiroirs cm.36,8x52x14,3 • 3 Cajones cm.36,8x52x14,3 cm. 45x56,6x79h 	1.256,00 41,5 / 0,29
BC4/645 01070454	<ul style="list-style-type: none"> 4 CASSETTI cm.36,8x52x8,9 • 4 Drawers cm.36,8x52x8,9 • 4 Schubladen cm.36,8x52x8,9 • 4 Tiroirs cm.36,8x52x8,9 • 4 Cajones cm.36,8x52x8,9 cm. 45x56,6x79h 	1.403,00 43,5 / 0,29
BC2/650 01070502	<ul style="list-style-type: none"> 2 CASSETTI cm.41,8x52x25 • 2 Drawers cm.41,8x52x25 • 2 Schubladen cm.41,8x52x25 • 2 Tiroirs cm.41,8x52x25 • 2 Cajones cm.41,8x52x25 cm. 50x56,6x79h 	1.195,00 40 / 0,32
BC3/650 01070503	<ul style="list-style-type: none"> 3 CASSETTI cm.41,8x52x14,3 • 3 Drawers cm.41,8x52x14,3 • 3 Schubladen cm.41,8x52x14,3 • 3 Tiroirs cm.41,8x52x14,3 • 3 Cajones cm.41,8x52x14,3 cm. 50x56,6x79h 	1.347,00 43 / 0,32

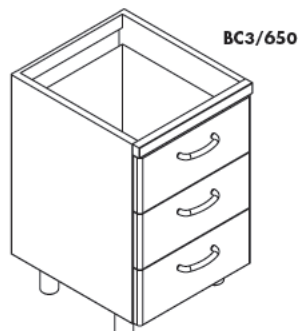
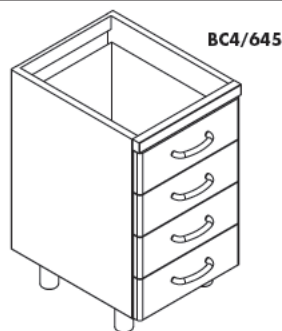
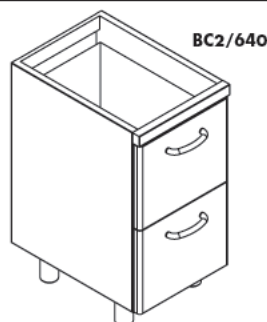
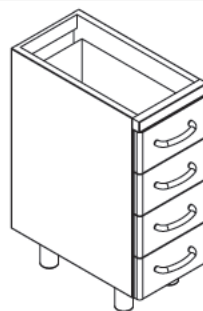

SHINE KITCHEN

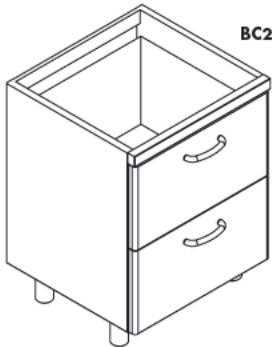
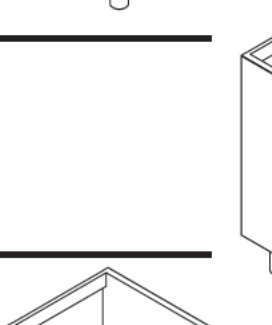
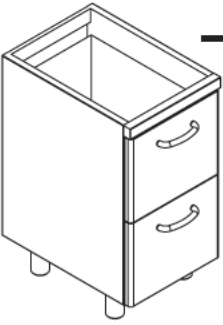
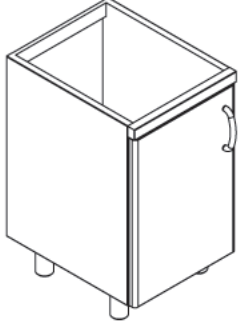
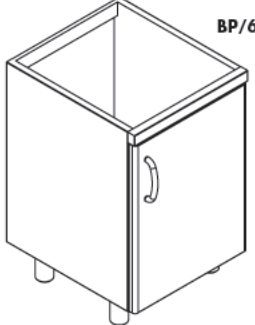
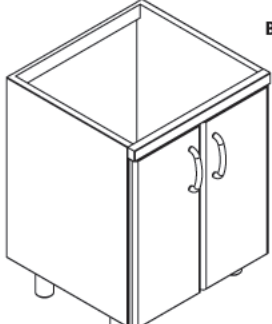
MOD. / COD.	DESCRIZIONE / DESCRIPTION / BEZEICHNUNG / DESCRIPTION / DESCRIPCIÓN DIMENSIONI / DIMENSIONS / ABMESSUNGEN / DIMENSIONS / DIMENSIONES		€ KG / M ³
BC1/660 01070601	1 CASSETTO cm.51,8x52x57,2 • 1 Drawer cm.51,8x52x57,2 • 1 Schubladen cm.51,8x52x57,2 • 1 Tiroir cm.51,8x52x57,2 • 1 Cajone cm.51,8x52x57,2 cm. 60x56,6x79h		1.074,00 41 / 0,37
BC2/660 01070602	2 CASSETTI cm.51,8x52x25 • 2 Drawers cm.51,8x52x25 • 2 Schubladen cm.51,8x52x25 • 2 Tiroirs cm.51,8x52x25 • 2 Cajones cm.51,8x52x25 cm. 60x56,6x79h		1.272,00 44 / 0,37
BC2B/640 01080402	2 BACINELLE INOXGN 1/1 h20 • 2 Containers inoxgn 1/1 h20 • 2 Behaltern inoxgn 1/1 h20 • 2 Bacs inoxgn 1/1 h20 • 2 Contenedores inoxgn 1/1 h20 cm. 40x56,6x79h		1.129,00 34 / 0,26
BP/630SX 01010301	BASE CON PORTA E RIPIANO INTERMEDIO • Storage unit with door and middle shelf • Flügeltürelement mit zwischenbord • Element de base avec porte et etagere intermediaire • Base con puerta y estante intermedio cm. 30x56,6x79h		573,00 18 / 0,20
BP/630DX 01010300	cm. 30x56,6x79h		573,00 18 / 0,20
BP/640SX 01010401	cm. 40x56,6x79h		588,00 21 / 0,26
BP/640DX 01010400	cm. 40x56,6x79h		588,00 21 / 0,26
BP/645SX 01010451	cm. 45x56,6x79h		616,00 22,5 / 0,29
BP/645DX 01010450	cm. 45x56,6x79h		616,00 22,5 / 0,29
BP/650SX 01010501	cm. 50x56,6x79h		625,00 24 / 0,32
BP/650DX 01010500	cm. 50x56,6x79h		625,00 24 / 0,32
BP/660 01010600	BASE CON PORTE, GUARNIZIONE E RIPIANO INTERMEDIO • Storage unit with doors , gasket and middle shelf • Flügeltürelement mit turdichtung und zwischenbord • Element de base avec portes, joint et etagere intermediaire • Base con puertas, guarnicion y estante intermedio cm. 60x56,6x79h		822,00 28 / 0,37
BP/670 01010700	cm. 70x56,6x79h		855,00 32 / 0,43
BP/680 01010800	cm. 80x56,6x79h		893,00 36 / 0,48
BP/690 01010900	cm. 90x56,6x79h		949,00 39 / 0,54
BP/6100 01011000	cm. 100x56,6x79h		996,00 42 / 0,60

SHINE KITCHEN

MOD. COD.	DESCRIZIONE/DESCRIPTION/BEZEICHNUNG/DESCRIPTION/DESCRIPCIÓN DIMENSIONI/DIMENSIONS/ABMESSUNGEN/DIMENSIONS/DIMENSIONES	PREZZO/PRICE PREIS/PRIX/PRECIO € KG / M ³
BP/6105 01011050	BASE CON 3 PORTE, GUARNIZIONI E RIPIANO INTERMEDIO • Storage unit with 3 doors , gaskets and middle shelf • Flügeltürelement mit 3 Türen, türdichtungen und zwischenbord • Element de base avec 3 portes , joints et etagere intermediaire • Base con 3 puertas, guarnicion y estante intermedio cm. 105x56,6x79h	1.188,00 43,5 / 0,63
BP/6110 01011100	cm. 110x56,6x79h	1.211,00 45 / 0,65
BP/6120 01011200	cm. 120x56,6x79h	1.256,00 48 / 0,71
BP/6125 01011250	cm. 125x56,6x79h	1.278,00 49,5 / 0,74
BP/6135 01011350	cm. 135x56,6x79h	1.325,00 52,5 / 0,79
BP/6150 01011500	cm. 150x56,6x79h	1.397,00 57 / 0,88
BPA/680 01110801	BASE AD ANGOLO CON PORTA E RIPIANO INTERMEDIO • Corner storage unit with door and middle shelf • Eck-element 90° mit tür und zwischenbord • Element de base d'angle avec porte et etagere intermediaire • Base angular con puerta y estante intermedio cm.80/80x56,6x79h	1.134,00 41 / 0,67

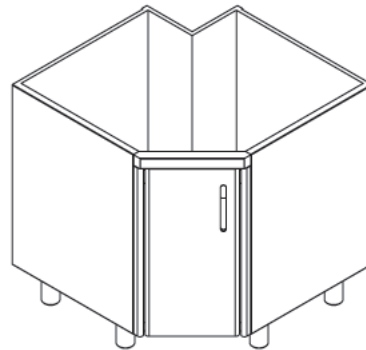
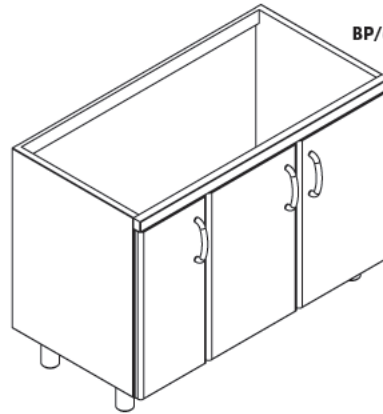

SHINE KITCHEN

MOD. COD.	DESCRIZIONE/DESCRIPTION/BEZEICHNUNG/DESCRIPTION/DESCRIPCIÓN DIMENSIONI/DIMENSIONS/ABMESSUNGEN/DIMENSIONS/DIMENSIONES	PREZZO/PRICE PREIS/PRIZ/PRECIO € KG / M³
PL/630 01310300	PIANO LAVORO CON ALZATINA E BORDO FRONTALE ARROTONDATO • Worktop with raised and rear border • Oberplatte mit aufkantung hinten und profile abgerundet. • Plan de travail avec joint de finition posterieur et borde frontal tombe' • Sobre de trabajo con peto trasero y borde frontal redondeado cm. 30x60x5h	161,00 5,5 / 0,04
PL/640 01310400	cm. 40x60x5h	184,00 7,5 / 0,05
PL/645 01310450	cm. 45x60x5h	208,00 8,5 / 0,06
PL/650 01310500	cm. 50x60x5h	218,00 9 / 0,07
PL/660 01310600	cm. 60x60x5h	229,00 11 / 0,08
PL/670 01310700	cm. 70x60x5h	253,00 13 / 0,09
PL/675 01310750	cm. 75x60x5h	264,00 23,5 / 0,10
PL/680 01310800	cm. 80x60x5h	288,00 14,5 / 0,10
PL/690 01310900	cm. 90x60x5h	298,00 16,5 / 0,11
PL/6100 01311000	cm. 100x60x5h	311,00 18,5 / 0,13
PL/6105 01311050	cm. 105x60x5h	322,00 19,5 / 0,13
PL/6110 01311100	cm. 110x60x5h	333,00 20 / 0,14
PL/6120 01311200	cm. 120x60x5h	344,00 22 / 0,15
PL/6125 01311250	cm. 125x60x5h	357,00 23 / 0,16
PL/6130 01311300	cm. 130x60x5h	368,00 24 / 0,16
PL/6135 01311350	cm. 135x60x5h	379,00 24,5 / 0,17
PL/6140 01311400	cm. 140x60x5h	413,00 25,5 / 0,17
PL/6150 01311500	cm. 150x60x5h	437,00 27,5 / 0,19
PL/6160 01311600	cm. 160x60x5h	459,00 29,5 / 0,20
PL/6165 01311650	cm. 165x60x5h	482,00 30,5 / 0,20
PL/6180 01311800	cm. 180x60x5h	517,00 33 / 0,22
PL/6195 01311950	cm. 195x60x5h	563,00 35,5 / 0,24
PL/6200 01312000	cm. 200x60x5h	586,00 36,5 / 0,24
PL/6210 01312100	cm. 210x60x5h	608,00 38,5 / 0,26
PL/6220 01312200	cm. 220x60x5h	632,00 40,5 / 0,27
PL/6225 01312250	cm. 225x60x5h	666,00 41,5 / 0,27
PL/6240 01312400	cm. 240x60x5h	712,00 44 / 0,29

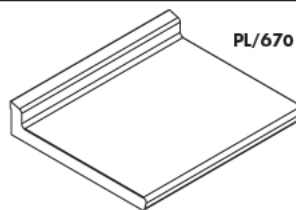

SHINE KITCHEN

MOD. COD.	DESCRIZIONE/DESCRIPTION/BEZEICHNUNG/DESCRIPTION/DESCRIPCIÓN DIMENSIONI/DIMENSIONS/ABMESSUNGEN/DIMENSIONS/DIMENSIONES	PREZZO/PRICE PREIS/PRIX/PRECIO € KG / M ³
PLA/680 01320800	PIANO LAVORO AD ANGOLO CON ALZATINA E BORDO FRONTALE ARROTONDATO <ul style="list-style-type: none"> • Corner worktop with raised and rear border • Oberplatte eck-element 90° mit 75mm aufkantung hinten und profile abgerundet. • Plan de travail d'angle avec joint de finition posterieur et bord frontal tombe' • Sobre de trabajo angular con peto trasero y borde frontal redondeado cm. 80/80x60x5h 	456,00 18 / 0,13
BPL/645DX 01030450	BASE PER LAVELLO CON PORTA <ul style="list-style-type: none"> • Storage unit for sink with door • Flügeltürelement für spulbecken • Element de base pour evier avec porte • Base para fregadero con puerta cm. 45x56,6x79h 	583,00 20,5 / 0,29
BPL/645SX 01030451	cm. 45x56,6x79h	583,00 20,5 / 0,29
BPL/660 01030600	BASE PER LAVELLO CON PORTE <ul style="list-style-type: none"> • Storage unit for sink with 2 doors • Flügeltürelement für spulbecken • Element de base pour evier avec 2 portes • Base para fregadero con puertas cm. 60x56,6x79h 	785,00 26 / 0,37
BPL/690 01030900	cm. 90x56,6x79h	893,00 37 / 0,54
BPL/6105 01031050	BASE PER LAVELLO CON 3 PORTE <ul style="list-style-type: none"> • Storage unit for sink with 3 doors • Flügeltürelement für spulbecken • Element de base pour evier avec 3 portes • Base para fregadero con 3 puertas cm. 105x56,6x79h 	924,00 41,5 / 0,63
BPL/6120 01031200	cm. 120x56,6x79h	1.167,00 45 / 0,71
BPL/6135 01031350	cm. 135x56,6x79h	1.218,00 49,5 / 0,79
BPL/6150 01031500	cm. 150x56,6x79h	1.267,00 54 / 0,88
BPAL/680 01130800	BASE PER LAVELLO AD ANGOLO CON PORTA <ul style="list-style-type: none"> • Corner storage unit for sink with door • Eck-element 90° für eckspulabdeckung mit flügeltüre • Element de base d'angle pour evier avec porte • Base angular para fregadero con puerta cm.80/80x56,6x79h 	1.150,00 37 / 0,67

SHINE KITCHEN

MOD. / COD.	DESCRIZIONE / DESCRIPTION / BEZEICHNUNG / DESCRIPTION / DESCRIPCIÓN DIMENSIONI / DIMENSIONS / ABMESSUNGEN / DIMENSIONS / DIMENSIONES	POTENZA / POWER / LEISTUNG / PUISSANCE / POTENCIA VOLTAGGIO / VOLTAGE / SPANNUNG / VOLTAGE / VOLTAJE	$\frac{kW}{kcal/h}$ / $\frac{kw}{V}$ / $\frac{Hz}{Hz}$	PREZZO / PRICE € PREIS / PRIX / PRECIO € KG / M ³
L/645 01330450	1 VASCA cm.29x35x14h • 1 Bowl cm.29x35x14h • 1 Becken cm.29x35x14h • 1 Bac cm.29x35x14h • 1 Cuba cm.29x35x14h cm. 45x60x5h			344,00 9,5 / 0,10
L/660 01330600	1 VASCA cm.34x39x19,5h • 1 Bowl right cm.34x39x19,5h with draining board • 1 Becken recht cm.34x39x19,5h mit abtropffläche • 1 Bac a droite cm.34x39x19,5h avec egouttoir • 1 Cuba a la derecha cm.34x39x19,5h con escurridor cm. 60x60x5h			422,00 12 / 0,15
L/691 DX 01330901	1 VASCA DX cm.34x39x19,5h CON SGOCCIOLATOIO • 1 Bowl right cm.34x39x19,5h with draining board • 1 Becken recht cm.34x39x19,5h mit abtropffläche • 1 Bac a droite cm.34x39x19,5h avec egouttoir • 1 Cuba a la derecha cm.34x39x19,5h con escurridor cm. 90x60x5h			513,00 18,5 / 0,22
L/691 SX 01330902	1 VASCA SX cm.34x39x19,5h CON SGOCCIOLATOIO • 1 Bowl left cm.34x39x19,5h with draining board • 1 Becken links cm.34x39x19,5h mit abtropffläche • 1 Bac a gauche cm.34x39x19,5h avec egouttoir • 1 Cuba a la izq. Cm.34x39x19,5h con escurridor cm. 90x60x5h			513,00 18,5 / 0,22
L/692 01330905	2 VASCHE cm.34x39x19,5h • 2 Bowls cm.34x39x19,5h • 2 Becken cm.34x39x19,5h • 2 Bacs cm.34x39x19,5h • 2 Cubas cm.34x39x19,5h cm. 90x60x5h			625,00 18,5 / 0,22
L/6105DX 01331051	1 VASCA DX cm.34x39x19,5h CON SGOCCIOLATOIO • 1 Bowl right cm.34x39x19,5h with draining board • 1 Becken recht cm.34x39x19,5h mit abtropffläche • 1 Bac a droite cm.34x39x19,5h avec egouttoir • 1 Cuba a la derecha cm.34x39x19,5h con escurridor cm. 105x60x5h			565,00 21,5 / 0,26
L/6105SX 01331052	1 VASCA SX cm.34x39x19,5h CON SGOCCIOLATOIO • 1 Bowl left cm.34x39x19,5h with draining board • 1 Becken links cm.34x39x19,5h mit abtropffläche • 1 Bac a gauche cm.34x39x19,5h avec egouttoir • 1 Cuba a la izq. Cm.34x39x19,5h con escurridor cm. 105x60x5h			565,00 21,5 / 0,26

SHINE KITCHEN

MOD. COD.	DESCRIZIONE/DESCRIPTION/BEZEICHNUNG/DESCRIPTION/DESCRIPCIÓN DIMENSIONI/DIMENSIONS/ABMESSUNGEN/DIMENSIONS/DIMENSIONES	POTENZA/POWER/LEISTUNG/PUISSANCE/POTENCIA VOLTAGGIO/VOLTAGE/SPANNUNG/VOLTAGE/VOLTAGE	$\frac{kW}{kcal/h}$ $\frac{V}{Hz}$	PREZZO/PRICE € PREIS/PRIX/PRECIO € KG / M ³
L/6121DX 01331201	1 VASCA DX cm.34x39x19,5h CON SGOCCIOLATOIO <ul style="list-style-type: none"> • 1 Bowl right cm.34x39x19,5h with draining board • 1 Becken recht cm.34x39x19,5h mit abtropffläche • 1 Bac a droite cm.34x39x19,5h avec egouttoir • 1 Cuba a la derecha cm.34x39x19,5h con escurridor cm. 120x60x5h 			622,00 24 / 0,29
L/6121SX 01331202	1 VASCA SX cm.34x39x19,5h CON SGOCCIOLATOIO <ul style="list-style-type: none"> • 1 Bowl left cm.34x39x19,5h with draining board • 1 Becken links cm.34x39x19,5h mit abtropffläche • 1 Bac a gauche cm.34x39x19,5h avec egouttoir • 1 Cuba a la izq. Cm.34x39x19,5h con escurridor cm. 120x60x5h 			622,00 24 / 0,29
L/6122DX 01331203	2 VASCHE DX cm.34x39x19,5h CON SGOCCIOLATOIO <ul style="list-style-type: none"> • 2 Bowls right cm.34x39x19,5h with draining board • 2 Becken recht cm.34x39x19,5h mit abtropffläche • 2 Bacs a droite cm.34x39x19,5h avec egouttoir • 2 Cubas a la derecha cm.34x39x19,5h con escurridor cm. 120x60x5h 			738,00 25 / 0,29
L/6122SX 01331204	2 VASCHE SX cm.34x39x19,5h CON SGOCCIOLATOIO <ul style="list-style-type: none"> • 2 Bowls left cm.34x39x19,5h with draining board • 2 Becken links cm.34x39x19,5h mit abtropffläche • 2 Bacs a gauche cm.34x39x19,5h avec egouttoir • 2 Cubas a la izq. Cm.34x39x19,5h con escurridor cm. 120x60x5h 			738,00 25 / 0,29
L/6135DX 01331353	2 VASCHE DX cm.34x39x19,5h CON SGOCCIOLATOIO <ul style="list-style-type: none"> • 2 Bowls right cm.34x39x19,5h with draining board • 2 Becken recht cm.34x39x19,5h mit abtropffläche • 2 Bacs a droite cm.34x39x19,5h avec egouttoir • 2 Cubas a la derecha cm.34x39x19,5h con escurridor cm. 135x60x5h 			792,00 28 / 0,33
L/6135SX 01331354	2 VASCHE SX cm.34x39x19,5h CON SGOCCIOLATOIO <ul style="list-style-type: none"> • 2 Bowls left cm.34x39x19,5h with draining board • 2 Becken links cm.34x39x19,5h mit abtropffläche • 2 Bacs a gauche cm.34x39x19,5h avec egouttoir • 2 Cubas a la izq. Cm.34x39x19,5h con escurridor cm. 135x60x5h 			792,00 28 / 0,33

SHINE KITCHEN

MOD. _____ COD. _____	DESCRIZIONE/DESCRIPTION/BEZEICHNUNG/DESCRIPTION/DESCRIPCIÓN DIMENSIONI/DIMENSIONS/ABMESSUNGEN/DIMENSIONS/DIMENSIONES	POTENZA/POWER/LEISTUNG/PUISSANCE/POTENCIA VOLTAGGIO/VOLTAGE/SPANNUNG/VOLTAGE/VOLTAJE	6kW kcal/h	7kw V~ Hz	PREZZO/PRICE € PREIS/PRIX/PREÇO € KG / M³
--	---	---	----------------------	------------------------	--

L/6150DX 2 VASCHE DX cm.34x39x19,5h CON SGOCCIOLATOIO
01331503

- 2 Bowls right cm.34x39x19,5h with draining board
- 2 Becken recht cm.34x39x19,5h mit abtropffläche
- 2 Bacs a droite cm.34x39x19,5h avec egouttoir
- **2 Cubas a la derecha cm.34x39x19,5h con escurridor cm. 150x60x5h**

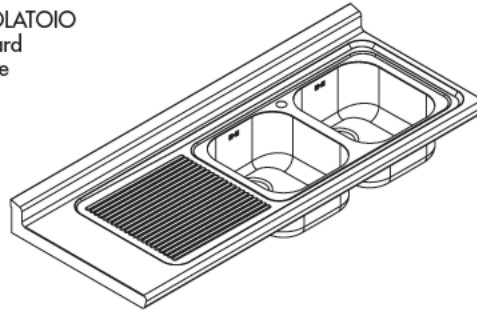

853,00
30,5 / 0,36

L/6150SX 2 VASCHE SX cm.34x39x19,5h CON SGOCCIOLATOIO
01331504

- 2 Bowls left cm.34x39x19,5h with draining board
- 2 Becken links cm.34x39x19,5h mit abtropffläche
- 2 Bacs a gauche cm.34x39x19,5h avec egouttoir
- **2 Cubas a la izq. Cm.34x39x19,5h con escurridor cm. 150x60x5h**

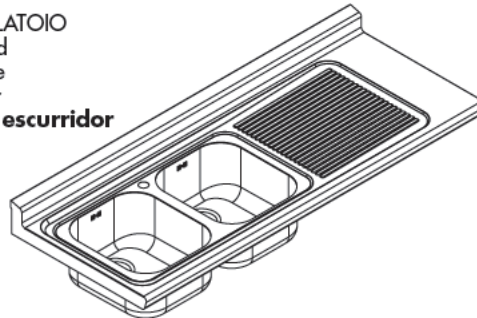

853,00
30,5 / 0,36

LA/680 1 VASCA cm.50x40x20h
01340800

- 1 Bowl cm.50x40x20h
- 1 Becken cm.50x40x20h
- 1 Bac cm.50x40x20h
- **1 Cuba cm.50x40x20h cm. 80/80x60x5h**

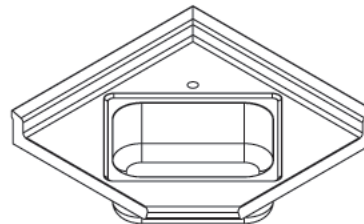

719,00
19 / 0,27

SHINE KITCHEN

MOD. COD.	DESCRIZIONE/DESCRIPTION/BEZEICHNUNG/DESCRIPTION/DESCRIPCIÓN DIMENSIONI/DIMENSIONS/ABMESSUNGEN/DIMENSIONS/DIMENSIONES	POTENZA/POWER/LEISTUNG/PUISSANCE/POTENCIA VOLTAGGIO/VOLTAGE/SPANNUNG/VOLTAGE/VOLTAJE	$\frac{kW}{kcal/h}$ $\frac{V}{Hz}$	PREZZO/PRICE € PREIS/PRIX/PRECIO € KG / M ³
PP/630DX 01210300	PENSILE CON PORTA E RIPIANO INTERMEDIO • Wall unit with door , and middle shelf • Wandhangeschrank mit tur , und zwischenbord • Armoire suspendue avec porte et etagere intermediaire • Armario de pared con puerta y estante intermedio cm. 30x40x69h			532,00 16 / 0,13
PP/630SX 01210301	cm. 30x40x69h			532,00 16 / 0,13
PP/640DX 01210400	cm. 40x40x69h			548,00 19 / 0,17
PP/640SX 01210401	cm. 40x40x69h			548,00 19 / 0,17
PP/645DX 01210450	cm. 45x40x69h			564,00 20,5 / 0,19
PP/645SX 01210451	cm. 45x40x69h			564,00 20,5 / 0,19
PP/650DX 01210500	cm. 50x40x69h			580,00 22 / 0,21
PP/650SX 01210501	cm. 50x40x69h			580,00 22 / 0,21
PP/660 01210600	PENSILE CON PORTE, GUARNIZIONE E RIPIANO INTERMEDIO • Wall unit with doors , gasket and middle shelf • Wandhangeschrank mit turen, turdichtungen und zwischenbord • Armoire suspendue avec portes, joint de porte et etagere intermediaire • Armario de pared con puertas, guarnicion y estante intermedio cm. 60x40x69h			729,00 26 / 0,24
PP/670 01210700	cm. 70x40x69h			758,00 29 / 0,28
PP/680 01210800	cm. 80x40x69h			789,00 33 / 0,32
PP/690 01210900	cm. 90x40x69h			834,00 36 / 0,35
PP/6100 01211000	cm. 100x40x69h			865,00 39 / 0,39
PP/6105 01211050	PENSILE CON 3 PORTE, GUARNIZION E RIPIANO INTERMEDIO • Wall unit with 3 doors , gasket and middle shelf • Wandhangeschrank mit 3 turen, turdichtungen und zwischenbord • Armoire suspendue avec 3 portes, joint de porte et etagere intermediaire • Armario de pared con 3 puertas, guarnicion y estante intermedio cm. 105x40x69h			1.038,00 40,5 / 0,41
PP/6110 01211100	cm. 110x40x69h			1.056,00 42 / 0,43
PP/6120 01211200	cm. 120x40x69h			1.088,00 45 / 0,46
PP/6125 01211250	cm. 125x40x69h			1.107,00 46,5 / 0,48
PP/6135 01211350	cm. 135x40x69h			1.167,00 49,5 / 0,52
PP/6150 01211500	cm. 150x40x69h			1.230,00 53 / 0,57
PPS/660 01230600	PENSILE SCOLAPIATTI CON PORTE, GUARNIZIONE E PORTAPIATTI • Wall unit plate rack with doors, gaskets and plate rack • Wandhangeschrank fur teller mit flugelturen und turdichtungen • Armoire egouttoir suspendue avec portes joints de porte, grille intermediaire porte-assiettes • Armario de pared escurridor con puerta y guarnicion cm. 60x40x69h			914,00 26 / 0,24
PPS/690 01230900	cm. 90x40x69h			1.001,00 34 / 0,35

SHINE KITCHEN

MOD. / COD.	DESCRIZIONE / DESCRIPTION / BEZEICHNUNG / DESCRIPTION / DESCRIPCIÓN DIMENSIONI / DIMENSIONS / ABMESSUNGEN / DIMENSIONS / DIMENSIONES	POTENZA / POWER / LEISTUNG / PUISSANCE / POTENCIA VOLTAGGIO / VOLTAGE / SPANNUNG / VOLTAGE / VOLTAJE	$\frac{kW}{kcal/h}$ / $\frac{kw}{V}$ / $\frac{Hz}{Hz}$	PREZZO / PRICE € PREIS / PRDX / PRECIO € KG / M ²
PPA/680 01260801	<p>PENSILE AD ANGOLO CON PORTA E RIPIANO INTERMEDIO</p> <ul style="list-style-type: none"> • Corner wall unit with door and middle shelf • Eck-wandhangeschrank mit flugelture und zwischenbord • Armoire d'angle suspendue avec 2 portes et etagere intermediaire • Armario angular de pared con puerta y estante intermedio <p>cm.80/80x40x69h</p>			1.217,00 38 / 0,59
PPV/630DX 01220300	<p>PENSILE CON PORTA VETRO E RIPIANO INTERMEDIO</p> <ul style="list-style-type: none"> • Wall unit with glass door and middle shelf • Wandhangeschrank mit glastur und zwischenbord • Armoire suspendue avec porte vitree et etagere intermediaire • Armario de pared con puerta vidriera y estante intermedio <p>cm. 30x40x69h</p>			588,00 16,5 / 0,13
PPV/630SX 01220301	cm. 30x40x69h			588,00 16,5 / 0,13
PPV/645DX 01220450	cm. 45x40x69h			648,00 21 / 0,19
PPV/645SX 01220451	cm. 45x40x69h			648,00 21 / 0,19
PPV/660 01220600	<p>PENSILE CON PORTE VETRO, GUARNIZIONE E RIPIANO INTERMEDIO</p> <ul style="list-style-type: none"> • Wall unit with glass doors, gasket and middle shelf • Wandhangeschrank mit 2 glasture, turdichtung und zwischenbord • Armoire suspendue avec 2 portes vitree , joint de porte et etagere intermediaire • Armario de pared con puertas vidriera, guarnicion y estante intermedio <p>cm. 60x40x69h</p>			828,00 27 / 0,24
PPV/690 01220900	cm. 90x40x69h			990,00 37 / 0,35
PPV/6105 01221050	<p>PENSILE CON 3 PORTE VETRO, GUARNIZIONI E RIPIANO INTERMEDIO</p> <ul style="list-style-type: none"> • Wall unit with 3 glass doors, gaskets and middle shelf • Wandhangeschrank mit 3 glasture, turdichtung und zwischenbord • Armoire suspendue avec 3 portes vitree , joint de porte et etagere intermediaire • Armario de pared con 3 puertas vidriera, guarnicion y estante intermedio <p>cm. 105x40x69h</p>			1.216,00 42 / 0,41
PPV/6135 01221350	cm. 135x40x69h			1.401,00 51 / 0,52

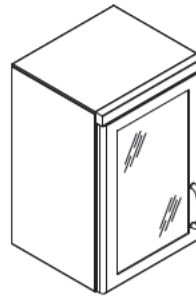
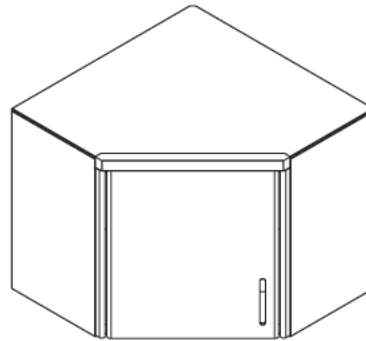

PPV/645SX

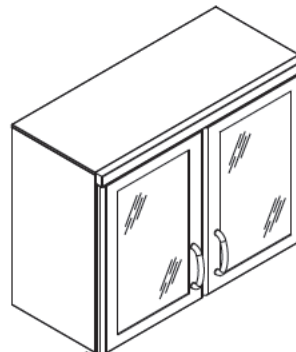

PPV690

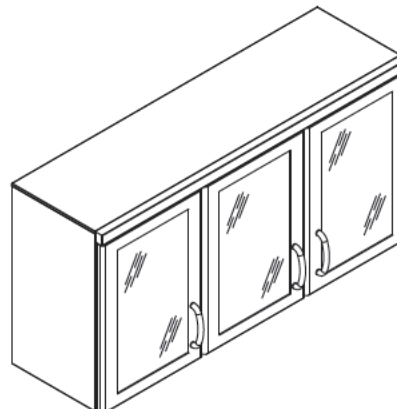

PPV/6135

SHINE KITCHEN

MOD. COD.	DESCRIZIONE/DESCRIPTION/BEZEICHNUNG/DESCRIPTION/DESCRIPCIÓN DIMENSIONI/DIMENSIONS/ABMESSUNGEN/DIMENSIONS/DIMENSIONES	POTENZA/POWER/LEISTUNG/PUISSANCE/POTENCIA VOLTAGGIO/VOLTAGE/SPANNUNG/VOLTAGE/VOLTAGE	kw kcal/h	kw V~ Hz	PREZZO/PRICE € PREIS/PRIX/PRECIO € KG / M³
--------------	---	---	--------------	----------------	--

A/660
01160600

ARMADIO CON PORTE,
GUARNIZIONI E 4 RIPIANI INTERMEDI

- Twin unit with doors, gasket and 4 middle shelves
- Hochschrank mit türen, turdichtungen und 4 zwischenborde
- Armoire a portes, joint de porte et 4 etageres intermediaires
- **Armario con puertas, guarniciones y 4 estantes intermedios**
cm. 60x60x220h

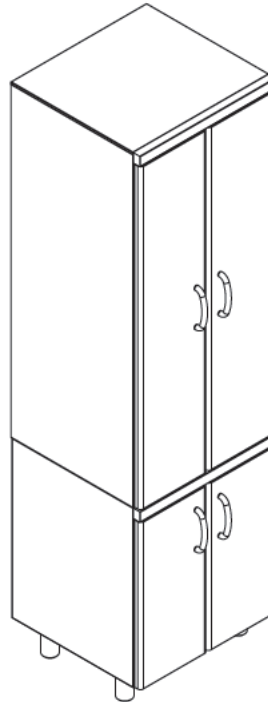

1.939,00
70 / 1,01

A/690
01160900

cm. 90x60x220h

2.327,00
99 / 1,46

AV/660
01170600

ARMADIO CON PORTE VETRO,
GUARNIZIONI E 4 RIPIANI INTERMEDI

- Twin unit with glass doors, gaskets and 4 middle shelves
- Hochschrank mit 4 glasturen, turdichtungen und 4 zwischenborde
- Armoire avec portes vitree, jointes de porte et 4 etageres intermediaires
- **Armario con puertas vidriera, guarniciones y 4 estantes intermedios**
cm. 60x60x220h



2.097,00
73 / 1,01

AV/690
01170900

cm. 90x60x220h

2.490,00
102 / 1,46

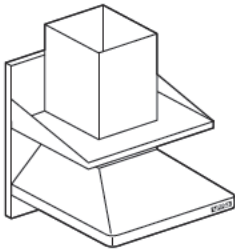
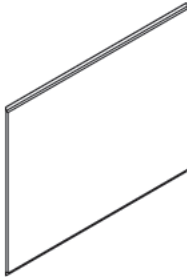
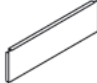
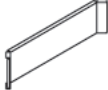
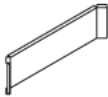

SHINE KITCHEN

MOD. / COD.	DESCRIZIONE / DESCRIPTION / BEZEICHNUNG / DESCRIPTION / DESCRIPCIÓN DIMENSIONI / DIMENSIONS / ABMESSUNGEN / DIMENSIONS / DIMENSIONES	POTENZA / POWER / LEISTUNG / PUISSANCE / POTENCIA VOLTAGGIO / VOLTAGE / SPANNUNG / VOLTAGE / VOLTAJE	$\frac{\text{kWh}}{\text{kcal/h}}$ / $\frac{\text{kw}}{\text{V}}$ / $\frac{\text{Hz}}{\text{Hz}}$	PREZZO / PRICE € PREIS / PRIX / PRECIO € KG / M ³
KSK/660 01280600	<p>CAPPA STILE CON PARETE E MENSOLA, ASPIRAZIONE AUTOFILTRANTE E CARBONI ATTIVI, 2 VELOCITA' E LUCE</p> <ul style="list-style-type: none"> • Selffilter extractor hood with wall and bracket, activated charcoal, 2 speed motor and light. • Selbstfiltrierende abzugshaube mit kohleaktivfiltern, 2-stufen gebläse, beleuchtung, wandverkleidung und konsolle. • Hotte d'aspiration de style autofiltrante, au charbon actif, moteur 2 vitesses, lumiere, paroi et atagere • Campana extractora con pared y repisa, con aspiracion autofiltrante y carbonos activos, 2 velocidades y luz. <p>cm. 60x60x70h</p>		$\frac{0,22 \text{ KW}}{230\text{V}\sim}$ 50 Hz	1.103,00 23 / 0,35
				
KSK/690 01280900	cm. 90x60x70h		$\frac{0,22 \text{ KW}}{230\text{V}\sim}$ 50 Hz	1.282,00 32 / 0,51
KSK/6100 01281000	cm. 100x60x70h		$\frac{0,22 \text{ KW}}{230\text{V}\sim}$ 50 Hz	1.486,00 33 / 0,57
SSP 01400000	<p>SCHIENA SOTTO PENSILI</p> <ul style="list-style-type: none"> • Splash back for wall unit • Rückwand für hochschrank • Finition dos pour armoires suspendue • Espalda debajo de armadio de pared a mt. 			245,00
				
ZB 01410000	<p>ZOCCOLATURA BASE</p> <ul style="list-style-type: none"> • Front plinth • Grundsockel • Plinthe frontal • Zocolos base a mt. 			114,00
				
ZA 01410002	<p>ZOCCOLATURA ANGOLO</p> <ul style="list-style-type: none"> • Corner plinth • Eke-sockel • Plinthe angle • Zocolos angular 			69,00
				
ZAF 01410003	<p>ZOCCOLATURA ANGOLO FINE LINEA</p> <ul style="list-style-type: none"> • Corner plinth end line • Eke-sockel ende linie • Plinthe angle fin du ligne • Zocolos angular conclusion de linea 			79,00
				

SHINE KITCHEN

MOD. COD.	DESCRIZIONE/DESCRIPTION/BEZEICHNUNG/DESCRIPTION/DESCRIPCIÓN DIMENSIONI/DIMENSIONS/ABMESSUNGEN/DIMENSIONS/DIMENSIONES	PREZZO/PRICE PREIS/PRIX/PRECIO € KG / M ³
PC PP/630 01430300	PROTEZIONE CAVO FARETTO • Cable protection of small lamp • Schutzkabel vom scheinwerfer • Protection cable pour lamp • Proteccion cable punto de luz cm. 30x1,2x2,9h	17,00
PC PP/640 01430400	cm. 40x1,2x2,9h	22,00
PC PP/645 01430450	cm. 45x1,2x2,9h	24,00
PC PP/650 01430500	cm. 50x1,2x2,9h	26,00
PC PP/660 01430600	cm. 60x1,2x2,9h	33,00
PC PP/670 01430700	cm. 70x1,2x2,9h	35,00
PC PP/680 01430800	cm. 80x1,2x2,9h	42,00
PC PP/690 01430900	cm. 90x1,2x2,9h	45,00
PC PP/6100 01431000	cm. 100x1,2x2,9h	48,00
PC PP/6105 01431050	cm. 105x1,2x2,9h	55,00
PC PP/6110 01431100	cm. 110x1,2x2,9h	58,00
PC PP/6120 01431200	cm. 120x1,2x2,9h	67,00
PC PP/6125 01431250	cm. 125x1,2x2,9h	71,00
PC PP/6135 01431350	cm. 135x1,2x2,9h	79,00
PC PP/6150 01431500	cm. 150x1,2x2,9h	86,00
KIT FARETTO 01420000	KIT FARETTO 20W I2000 (FARETTO,GHIERA,STAFFA) • Kit small lamp 20w I2000 • Kit scheinwerfer 20w I2000 • Kit lampe 20w I2000 • Punto de luz 20w I2000)	0,02 kW 12 V
TRASFORMATORE 01420001	TRASFORMATORE 230V-12V 10-60W • Transformer 230v-12v- 10-60w • Verwandler 230v-12v-10-60vv • Transformateur 230v-12v-10-60w • Acomodatriz de corriente 230v-12v 10-60w	69,00
PROLUNGA BT 01420002	PROLUNGA 12V I1500 • Extension 12v-I1500 • Fortsatz 12v I1500 • Rallonge 12v I1500 • Prolonga 12v I1500	38,00

SHINE KITCHEN

MOD. COD.	DESCRIZIONE/DESCRIPTION/BEZEICHNUNG/DESCRIPTION/DESCRIPCIÓN DIMENSIONI/DIMENSIONS/ABMESSUNGEN/DIMENSIONS/DIMENSIONES		PREZZO/PRICE € PREIS/PRIX/PRECIO € KG / M³
GD 51261000	<p>GRUPPO RUBINETTO A DOPPIA EROGAZIONE</p> <ul style="list-style-type: none"> • Tap for sink with dual mains supply • Mischbatterie • Groupe robinet a double refoulement • Grupo grifo con doble erogacion 		101,00
GL 51262000	<p>GRUPPO RUBINETTO A LEVA, A NORME IGENICHE</p> <ul style="list-style-type: none"> • Lever tap for sink in accordance with sanitary regulations • Einhebel-mischbatterie • Groupe robinet a levier, aux normes hygieniques • Grupo grifo con palanca segun normas higienicas 		231,00
SER 01440000	<p>KIT SERRATURA CON CHIAVE</p> <ul style="list-style-type: none"> • Kit lock with keys • Kit schloss kt schlussel • Serrure avec clés • Cerradura con llave 		48,00